

## SSBVF Stainless Steel Ball Valve Flanged, Class-150

### Product Description

HSN 84818090

Product : Sant Stainless Steel Ball Valve (F), SS (304)  
 Pressure/Class/Rated : Class-150  
 Body Material Cum Standard : S.S. AISI-304 (CF-8)  
 Product Description : 3 Pc Design Lever Operated  
 Type of Seat : Renewable  
 Stem : AISI-410  
 Ball : AISI-304 (CF-8)  
 Seat Ring & Gland Packing : PTFE  
 End Details : Flanges as per B 16.5 Class-150 (Drilled)



### Testing & Certification

Body Test Pressure : 30 Barg (435psig. Hyd.)  
 Seat Test Pressure : 22 barg (320psig. Hyd.)  
 Maximum Working Temp. : 225°C

Our Works' Test Certificate is furnished with every supply.

### Materials of Construction

| Components   | Materials | Specifications |
|--|-----------|----------------|
| Body, Connector  | C.S.S.    | ASTMA 351-CF8  |
| Ball, Stem, Gland, Spring Washer, Lever Nut, Fasteners | S.S.      | AISI-304       |
| Seat, Gland Packing                                    | PTFE      | —              |
| Lever  | S.S.      | —              |

### Dimensions (in mm)

| Nominal Size | Nominal Size (Inches) | LL  | F±2   |
|--------------|-----------------------|-----|-------|
| 15           | 1/2                   | 137 | 108±2 |
| 20           | 3/4                   | 140 | 117±2 |
| 25           | 1                     | 160 | 127±2 |
| 32           | 1.1/4                 | 160 | 140±2 |
| 40           | 1.1/2                 | 195 | 165±2 |
| 50           | 2                     | 200 | 178±2 |
| 65           | 1/2                   | 230 | 190±2 |
| 80           | 3/4                   | 250 | 203±2 |
| 100          | 1                     | 270 | 229±2 |

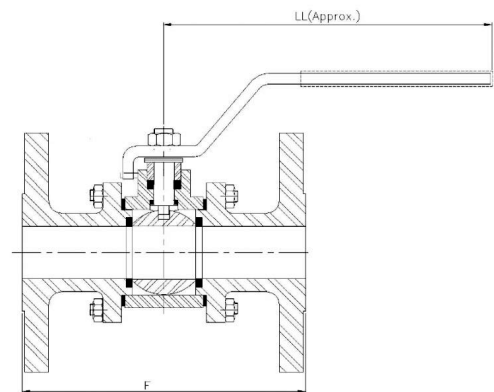

### Notes

1. Product images are for illustration purposes only. Actual product may vary.
2. Actual dimensions may change over time, due to continual design improvements. Please confirm before placing order.