

SBM-9 Bronze Horizontal Lift Check Valve Standard, Screwed

Product Description

HSN 84813000

Product : 'SBM' Bronze Horizontal Lift Check Valve No.4
 Type of Pattern : Standard Pattern
 Body Material cum Standard : GM (IS:318 Gr.LTB2)
 Description : Screwed in Cover
 Type of Seat : Integral seat
 Type of Disc : Renewable disc
 Trim : Cu-Alloy
 End Details : Screwed Female BSP threads to BS 21.

Testing & Certification

Body Test Pressure : 21.09Kg/cm²g (300Psig. Hyd.)
 Seat Test Pressure : 14.06Kg/cm²g (200Psig. Hyd.)

Our Works' Test Certificate is furnished with every supply.

Application

Water	Oil
-------	-----



Materials of Construction

Components	Materials	Specifications
Body, Cover & Valve Disc	Leaded Tin Bronze	IS:318 Gr.LTB2

Dimensions (in mm)

Nominal Size	Nominal Size (Inches)	F	H
8	1/4	38	30
10	3/8	41	30
15	1/2	48	35
20	3/4	56	35
25	1	67	45
32	1.1/4	80	55
40	1.1/2	90	55
50	2	106	65
65	2.1/2	135	85
80	3	156	100
100	4	190	115

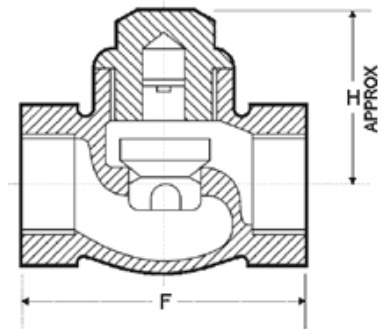

Notes

- Product images are for illustration purposes only. Actual product may vary.
- Actual dimensions may change over time, due to continual design improvements. Please confirm before placing order.