

## DP Dual Plate Water Check Valve

### Product Description

HSN 84813000

Product : Sant Dual Plate Wafer Check Valve  
 Pressure Rating : PN-16  
 Body Material cum Standard : Cast Iron  
 Pressure Description : Wafer Type Spring Loaded  
 Type of Seat : EPDM Rubber Lining  
 Type of Disc : Ductile Iron Disc  
 Trim : Spring & Pins SS 304  
 End Details : Wafer type suitable for clamping between flanges as per ASME B 16.5 Class-150



### Testing & Certification

Body Test Pressure : 24 Kg/cm<sup>2</sup>  
 Seat Test Pressure : 16 Kg/cm<sup>2</sup>

### Materials of Construction

Components	Materials	Specifications
Body	Cast Iron	—
Body Seat	Rubber	E.P.D.M
Disc	D.I (SG Iron)	—
Hinge Pin	SS	AISI-420
Stop Pin	SS	AISI-420
Spring	Spring Steel	AISI-304
Bush/Bearing	P.T.F.E	—
Plug	SS	AISI-410

### Dimensions (in mm)

Size	F±2	D
50	54	107
65	54	127
80	57	142
100	64	164
125	70	192
150	76	218
200	95	273
250	108	328
300	145	378
350	185	438
400	188	487

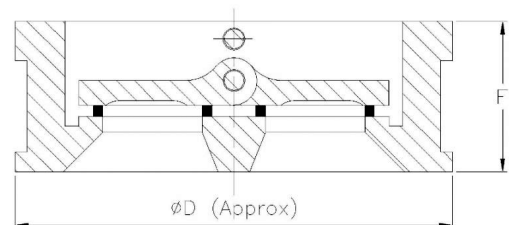

### Notes

1. Product images are for illustration purposes only. Actual product may vary.

2. Actual dimensions may change over time, due to continual design improvements. Please confirm before placing order.