

## CS-7B Cast Steel Gate Valve Flanged, Class-600

### Product Description

HSN 84818030

Product : Sant Cast Steel Gate Valve  
 Product Standard : Conforming to BS-1414/API 600  
 Type of Pattern : Straight Type  
 Pressure / Class Rating : Class 600  
 Body Material cum standard : CCS (ASTM A-216 Gr. WCB)  
 Product Description : Bolted Bonnet O/S Yoke Type Rising Stem  
 Type of Seat : Renewable  
 Type of Wedge : Solid/Flexible Wedge  
 Trim : SS AISI-410 & Aluminium Bronze Sleeves  
 End Details : Flanges as per ASME B 16.5 Class 600 RF Undrilled



### Testing & Certification

Body Test Pressure : 153 Barg (2220 Psig.) Hyd.  
 Seat Test Pressure : 112 Barg (1630 Psig.) Hyd.  
 Seat Test Pressure : 6.9 barg 100 Psig. (AIR)

Our Works' Test Certificate is furnished with every supply.

### Materials of Construction

Components	Materials	Specifications
Body, Bonnet, Yoke, Gland Flange	Cast Carbon Steel	ASTM A216 Gr.WCB
Wedge	Cast Carbon Steel with SS Weld Deposit	ASTM A216 Gr.WCB / AISI-410
Gasket	Spiral Wound S.S.	AISI-304
Gland Packing	Expanded Pure Flexible Graphite	—
Handwheel	S.G. Iron	—
Body Rings, Gland Yoke Follower, Sleeve Nut, Stem, Backseat Bush, Locking Screws	Stainless Steel	AISI-410
Gland Bolting	Carbon Steel	—
Bolts	Alloy Steel	ASTM A193 Gr.B7
Nuts	HT Steel	ASTM A194 Gr.2H
Yoke Sleeve	Al Bronze	—

### Dimensions (in mm)

Nominal Size	Nominal Size (Inches)	F±2	H (Approx.)	ØW (Approx.)
40	1.1/2	241	350	229
50	2	292	400	229
65	2.1/2	330	425	229
80	3	356	465	254
100	4	432	560	305
125	5	508	665	405
150	6	559	760	450
200	8	660	925	500

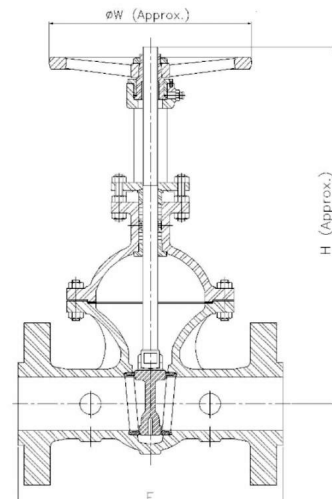

Nominal Size	Nominal Size (Inches)	F±2	C (Approx)	ØW			
250	10	330	925	450			
300	12	356	1060	500			

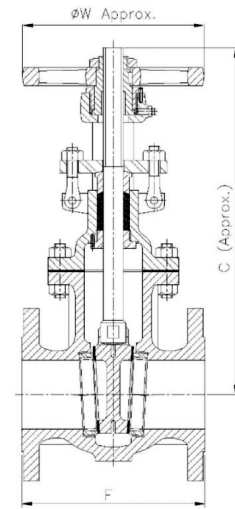

Notes

1. Product images are for illustration purposes only. Actual product may vary.
2. Actual dimensions may change over time, due to continual design improvements. Please confirm before placing order.