

CI-5A Cast Iron Accessible Feed Check Valve Flanged, without Inspection Branch (IBR Approved)

Product Description

HSN 84813000

Product : 'SANT' Cast Iron Accessible Feed Check Valve
 Type of Pattern : Right Angle
 Body Material cum Standard : Cast Iron IBR 86 to 93 Gr.A
 Description : Straight Inlet without Inspection Branch
 Type of Seat : Renewable seat
 Type of Disc : Renewable disc
 Trim : SS AISI-410
 Gland Packing : Expanded Pure Flexible Graphite
 End Details : Flanges as per BS 10 Table F & H F.F. undrilled



Testing & Certification

TABLE - F

Body Test Pressure : 21.09Kg/cm²
 Seat & Backseat Test Pressure : 10.54Kg/cm²
 Working Pressure : Max BOP 10.54Kg/cm² (150 Psig.) at 220°C Steam

TABLE - H

Body Test Pressure : 26Kg/cm²
 Seat & Backseat Test Pressure : 13Kg/cm²
 Working Pressure : Max BOP 13Kg/cm² (185 Psig.) at 220°C Steam

Test Certificate in Form III-C as per IBR is furnished with every supply.

Application

Water	Steam
-------	-------

Materials of Construction

Components	Materials	Specifications
Body, Bonnet, Valve Disc, Gland & Handwheel	Cast Iron	IBR 86 to 93 Gr.A
Body Seat Ring, Valve Disc Rings & Check Nut	Stainless Steel	AISI-410
Gasket	Compressed Asbestos Fiber	IS:2712 Gr.C
Gland Packing	Expanded Pure Flexible Graphite	—
Fasteners	Mild Steel	—
Yoke Bush	Aluminum Bronze	—

Dimensions (in mm)

Nominal Size	Nominal Size (Inches)	B±2	C (Closed)	G±2	ØW
25	1	225	180	100	125
32	1.1/4	240	190	105	125
40	1.1/2	265	210	115	160
50	2	280	220	125	160
65	2.1/2	300	250	145	200

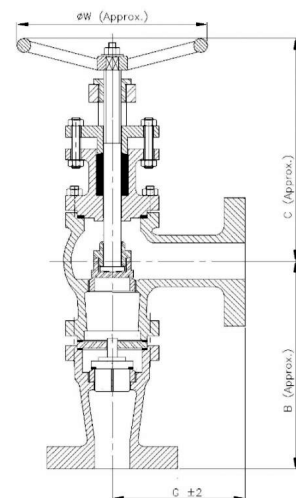

Notes