

## IS-9 Bronze Globe Valve Rising Stem, Screwed, IS : 778 Class-1 (ISI Marked)

### Product Description

HSN 84818030

Product : 'SANT' Bronze Globe Valve  
 Product Standard : IS-778  
 Pressure/Class/Rating : Class-1  
 Body Material cum Standard : GM ( IS:318 Gr.LTB2 )  
 Description : Screwed in Bonnet, Inside Screw, Rising Stem  
 Type of Seat : Integral seat  
 Trim : Cu-Alloy  
 Gland Packing : PTFE  
 End Details : Screwed female threads to IS:554 Parallel

### Testing & Certification

Body Test Pressure : 1.5 MPa Hyd.  
 Seat & Back Seat Test Pressure : 1.0 MPa Hyd.  
 Max Working Temperature: 45°C

Our Works' Test Certificate is furnished with every supply.

### Application

Water	Oil
-------	-----



### Materials of Construction

Components	Materials	Specifications
Body, Bonnet, Disc, Stuffing Box, Gland & Gland Nut, Disc Nut	Leaded Tin Bronze	IS:318 Gr.LTB2
Stem	Forged Brass	IS:6912 Gr.FLB
Handwheel	Cast Iron / Steel	IS:210 Gr.FG200
Gland Packing	PTFE	---
Screw & Washer for Handwheel	Mild Steel	---

### Dimensions (in mm)

Nominal Size	Nominal Size (Inches)	F	H (Approx.)	ØW (Approx.)
8	1/4	47±1.5	75	50
10	3/8	50±1.5	75	50
15	1/2	60±1.5	85	60
20	3/4	70±1.5	90	60
25	1	80±1.5	115	65
32	1.1/4	95±1.5	120	75
40	1.1/2	110±1.5	130	90
50	2	125±1.5	135	90
65	2.1/2	160±1.5	170	140
80	3	180±1.5	200	175
100	4	216±1.5	230	200

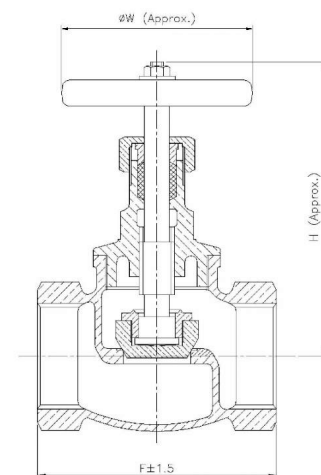

### Notes

- Product images are for illustration purposes only. Actual product may vary.
- Actual dimensions may change over time, due to continual design improvements. Please confirm before placing order.