

## IBR-9BR Bronze Controllable Feed Check Valve Right Angle, Flanged (IBR Approved)

### Product Description

HSN 84813000

Product : 'SANT' Bronze Controllable Feed Check Valve  
 Type of Pattern : Right Angle  
 Body Material cum Standard : Bronze IBR 282(a)(iv) Gr.B  
 Description : Screwed in Bonnet, OS Yoke Type , Rising Stem (15mm to 32mm)  
 Bolted Bonnet, OS Yoke Type, Rising Stem (40mm to 50mm)  
 Type of Seat : Renewable Seat  
 Type of Disc : Renewable Disc  
 Trim : SS AISI-410  
 Gland Packing : Expanded Pure Flexible Graphite  
 End Details : Flanges as per BS 10 Table H F.F. undrilled



### Testing & Certification

Body Test Pressure : 500 Psig.Hyd.  
 Seat Test Pressure : 500 Psig. Hyd. & 250 Psig. Steam  
 Working Pressure : Max.BOP 250 Psig.(17.58Kg/cm<sup>2</sup>)  
 Maximum Working Temperature: 225°C (435°F)

Test Certificate in Form III-C as per IBR is furnished with every supply.

### Application

Water	Steam
-------	-------

### Materials of Construction

Components	Materials	Specifications
Body, Bonnet, Check Nut & Gland	Bronze	IBR 282(a)(iv) Gr.B
Body Seat Ring, Valve Disc & Stem	Stainless Steel	AISI-410
Handwheel	Cast Iron	IBR 86 to 93 Gr.A
Gland Packing	Expanded Pure Flexible Graphite	—
Fasteners, Washer & Nut for Handwheel	Mild Steel	—

### Dimensions (in mm)

Nominal Size	Nominal Size (Inches)	F	H (Approx.)	ØW (Approx.)
15	1/2	73±1.5	127	70
20	3/4	76±1.5	133	70
25	1	83±1.5	140	90
32	1.1/4	89±1.5	172	100
40	1.1/2	95±1.5	178	127
50	2	108±1.5	200	144

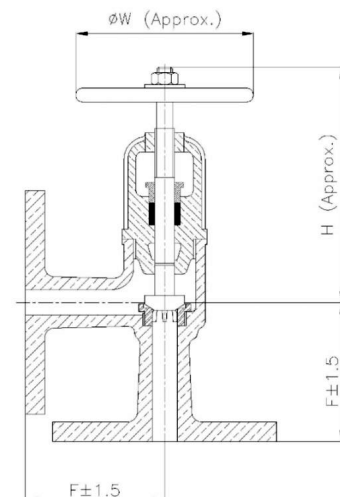

### Notes

- Product images are for illustration purposes only. Actual product may vary.
- Actual dimensions may change over time, due to continual design improvements. Please confirm before placing order.