

IBR-18 Bronze Accessible Feed Check Valve Flanged, Straight Inlet / Curved Inlet (IBR Approved)

Product Description

HSN 84813000

Product : 'SANT' Bronze Accessible Feed Check Valve
 Body Material cum Standard : Bronze IBR 282(a)(iv) Gr.B
 Description : Right Angle Body Straight Inlet / Curved Inlet
 Type of Seat : Renewable seat
 Type of Disc : Renewable disc
 Trim : SS AISI410 / Monel
 Gland Packing : Expanded Pure Flexible Graphite
 End Details : Flanges as per BS 10 Table H F.F. undrilled

Testing & Certification

Hydraulic Test Pressure : 500 Psig.Hyd.
 Working Pressure : Max.BOP 250 Psig.(17.58Kg/cm²)
 Maximum Working Temperature : 435°F (225°C)

Test Certificate in Form III-C as per IBR is furnished with every supply.

Application

Water	Steam
-------	-------



Materials of Construction

Components	Materials	Specifications
Body, Bonnet, Check Nut & Gland	Bronze	IBR 282(a)(iv) Gr.B
Body Seat Ring, Valve Disc	S.S.	AISI-410
Stem	Stainless Steel	AISI-410
Gland Packing	Expanded Pure Flexible Graphite	—
Fasteners	Mild Steel	—
Handwheel	Cast Iron	IBR 86 to 93 Gr.A
Nut & Washer for Handwheel	Mild Steel	—

Dimensions (in mm)

Nominal Size	Size (Inches)	A	B	H	W
20	3/4	65	125	120	70
25	1	115	150	140	100
32	1.1/4	112	160	160	115
40	1.1/2	102	142	203	125
50	2	102	170	203	145

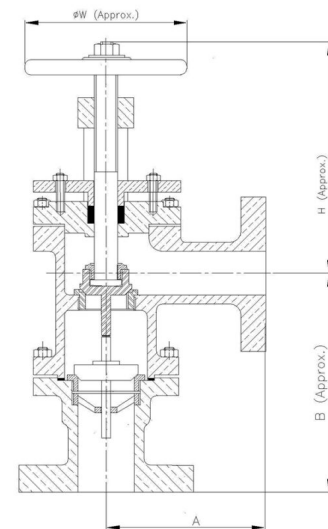

Notes

1. Product images are for illustration purposes only. Actual product may vary.