

BBVF Brass Ball Valve with Flare Nut Screwed

Product Description

HSN 90282000

Product : Sant Brass Ball Valve with Flare Nut
 Type of Pattern : Two Pcs design with Lever Operated and Flare Nut
 Body & Bonnet : Brass
 Type of Ball : Brass Chrome Plated
 Type of Seats : PTFE Renewable Seats
 Stem : Brass
 Packing : PTFE
 End Details : Screwed end BSP Female Threads and one end with Swivel Nut (End connection 5/8")



Testing & Certification

Body Test Pressure : 20kg/cm²g (Hyd.)
 Seat Test Pressure : 13.5kg/cm²g (Hyd.)

Materials of Construction

Components	Materials	Specifications
Nut	S.S.	-
Gland	Brass	-
Gland Seal	PTFE	-
Body of Ball Valve	Brass	-
Seat	PTFE	-
Ball	Brass	-
Stem	Brass	-
Flare Nut	Brass	-
Lever	M.S (Power Coated)	-

Dimensions (in mm)

Size	F	LL	T
20	77	100	3/4" BSP
25	77	100	1" BSP

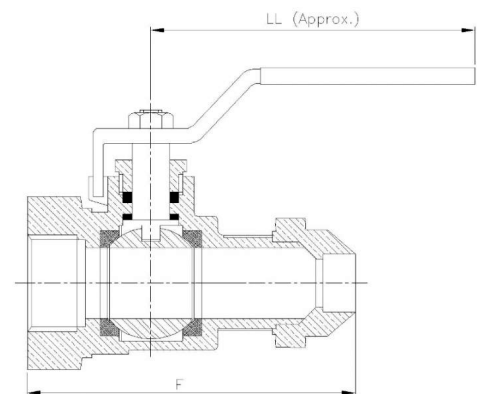

Notes